

RESOLUTION NO. 05-43

**A RESOLUTION OF THE MAYOR AND COMMON COUNCIL OF THE CITY OF MARICOPA, ARIZONA, ACCEPTING PUBLIC IMPROVEMENTS AND MAINTENANCE RESPONSIBILITY FOR ALL STREETS WITHIN THE ALTERRA SUBDIVISION PARCELS 3 AND 3A, INTO THE CITY STREET/ROAD MAINTENANCE SYSTEM.**

**WHEREAS**, the City has received a request from the owner/developer to accept public improvements and maintenance responsibility for all streets within the Alterra Subdivision Parcels 3 and 3A, into the City street/road maintenance system.

**WHEREAS**, it appears that the public improvements in question have been properly dedicated for public use; and

**WHEREAS**, the Maricopa Public Works Department has inspected the public improvements and has notified the Maricopa City Council that the public improvements have been installed to the satisfaction of the Maricopa Public Works Department; and

**WHEREAS**, it appears to the Maricopa City Council that the current owner has paid to the City the appropriate Subdivision Street Maintenance Fee, as established by Resolution 04-16, and any other applicable fees relating to the property;

**NOW, THEREFORE, BE IT RESOLVED** that the Maricopa City Council hereby accepts all streets within the Alterra Subdivision Parcels 3 and 3A, as indicated on the map attached as Exhibit "A" hereto, into the City road system for purposes of public use, ownership and future maintenance. This Resolution shall be in full force and effect from and after its passage.

PASSED AND ADOPTED BY THE Mayor and Council of the City of Maricopa, Arizona, this 6<sup>th</sup> day of December, 2005.

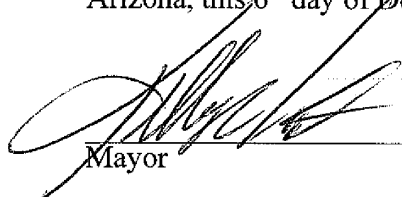
  
\_\_\_\_\_  
Mayor

ATTEST:

APPROVED AS TO FORM:

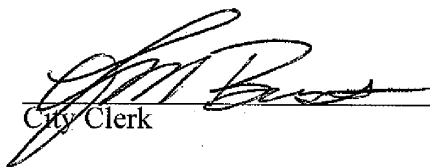
  
\_\_\_\_\_  
City Clerk

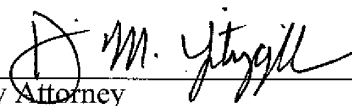
  
\_\_\_\_\_  
City Attorney

***EXHIBIT "A"***

---

# ALTERRA NORTH

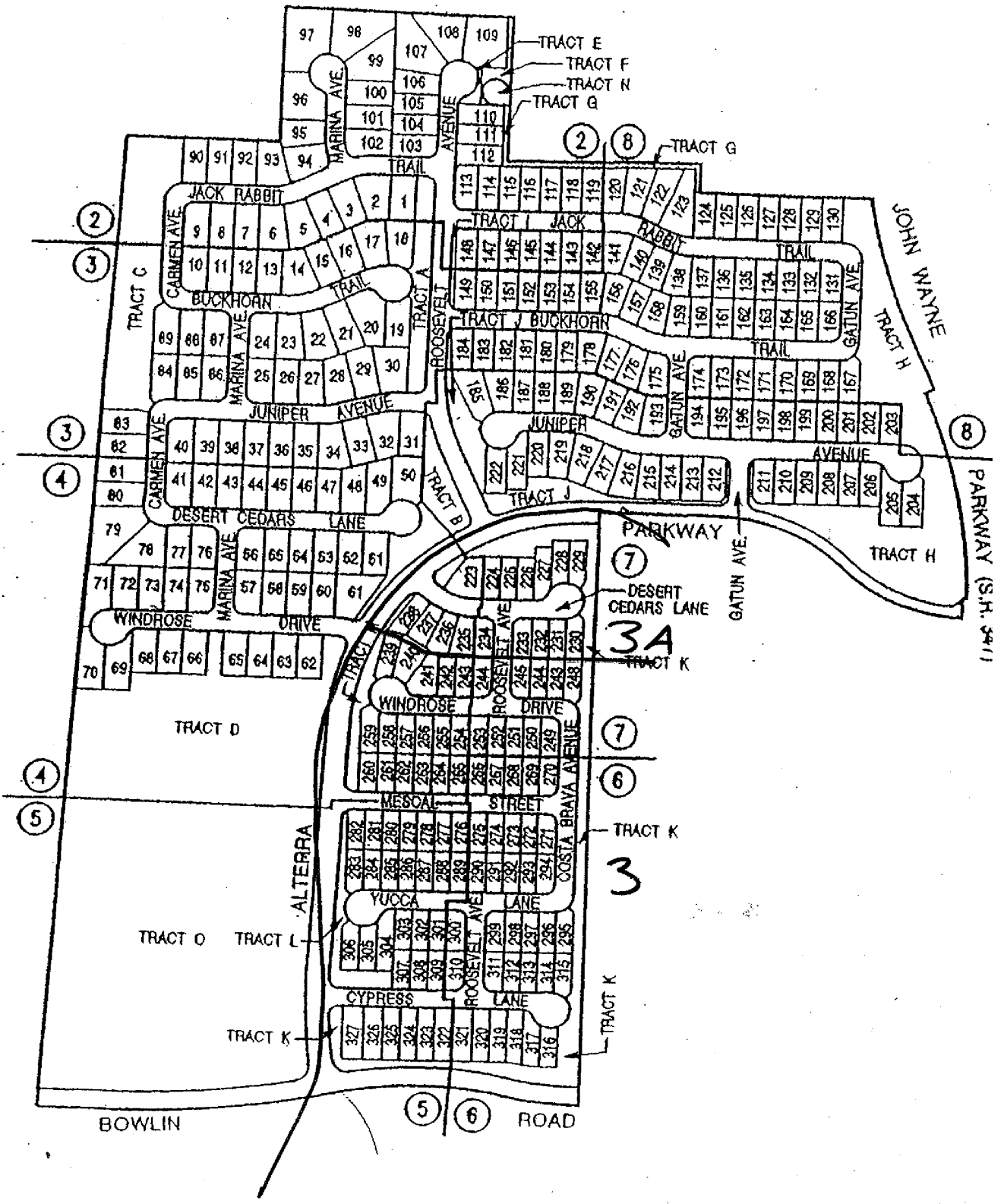

BOWLIN

ROAD

PARKWAY (S.H. 3411)

TRACT O TRACT L

TRACT K

TRACT K

TRACT K

TRACT E  
TRACT F  
TRACT N  
TRACT G

TRACT G

TRACT JACK

TRACT J BUCKHORN

TRACT J JUNIPER

PARKWAY

DESERT CEDARS LANE

TRACT K

TRACT K

3

7

7

6

7

6

7

6

5

6

5

6

5

6

5

6